

FIELD COPY

1

COUNTY OF LOS ANGELES

ROAD DEPARTMENT



WATTS QUAD

BENCH MARKS

1960

FIELD COPY

PREFACE

The Road Department level net is composed of some 1,000 miles of levels supporting more than 10,000 bench marks. In 1955, a major re-adjustment of the net was undertaken resulting in revised bench mark elevations of which the accompanying list is a part.

To facilitate the adjustment, indexing, and distribution of adjusted values of the net, the county territory was divided into 30 quads or areas. For identification purposes each quad was given a name, viz., "Rosemead", "La Mirada", "Santa Fe", etc. When bench marks and elevations in the Road Dept. net are used, the name of the quad in which the bench mark is located and the date of the adjustment of the elevation must be included in the bench mark description, e.g.,

SG 908 - L & T in E. cb. Miscatel Ave. on C/L prod.
Scott St. (Rosemead - 1955) Elev. 333.517

It is expected that this general adjustment will, for the most part, remain sound for the next 15 or 20 years. As new circuits are completed, however, re-adjustment of individual quads may become advisable. It is expected that these subsequent adjustments will be in the nature of a few hundredths of a foot. When a quad is re-adjusted, new elevation lists will be published and the date of the re-adjustment will replace the "1955" at the end of the bench mark description. Two bench marks in the same quad with different adjustment dates will not normally join each other. Since all adjustments taper out to nothing at the periphery of the quad, any bench mark in one quad will join any bench mark in another quad regardless of their respective adjustment dates.

The basic accuracy of the net is reflected by an indicated field probable error of ± 0.12 foot per mile of leveling as determined from 298 conditions of closure. However, many years experience in vertical control in the greater Los Angeles basin & Antelope Valley indicate that because of varying degrees of subsidence and heaving, the true datum is recovered only by obtaining substantial agreement of a number of bench marks.

The users of this net are invited to assist in its maintenance by notifying this Department of cases of obliteration, apparent mistakes in descriptions or elevations, and proven disturbance of bench marks.

Datum: U.S. Coast and Geodetic Survey Sea Level Datum of 1929, through the medium of the Los Angeles County Engineer Precise Level Net, 1952 Adjustment.

Abbreviations Used in Bench Mark Listings

ABUT--Abutment	L+BN--Lead and Bench Mark Nail
ANG PT--Angle Point	L+BR--Lead and Brad
BC--Beginning of Curve	L+N--Lead and Nail
BCR--Beginning of Curb Return	L+PK--Lead and PK Nail
BLDG--Building	L+SPK--Lead and Spike
BT SPK--Boat or Bolt Spike	L+T--Lead and Tack
CB RET--Curb Return	MCR--Middle of Curb Return
C/L INT--Center Line Intersection	MKD--Marked
C/L PROD--Center Line Produced	NR--Near
COE--Corps of Engineers	OPP--Opposite
CONC--Concrete	PI--Point of Intersection
CS MON--County Surveyor Monument	PK+W--PK Nail and Washer
CS BR CAP--County Surveyor Brass Cap Monument	P/L--Property Line
CT SPK--Cut Spike	P O S T--Point on Semi-tangent
CTR--Center	PP--Power Pole
DN--Down	PVMT--Pavement
DR--Driveway	R D--Road Department
EC--End of Curve	RDEM--Road Department Bench Mark
ENT--Entrance	RR--Railroad
FC--Flood Control (Dept. LA County)	SPK T+W--Spike, Tin and Washer
FTG--Footing	USC+GS--United States Coast and Geodetic Survey
HDWL--Headwall	USGS--United States Geological Survey
HSE--House	WK--Walk
IP--Iron Pipe	±--Plus or Minus
LACE--Los Angeles City Engineer	+--And

SLAUSON AVE.

CRENSHAW BLVD.

WATTS QUAD

LOS ANGELES COUNTY ROAD DEPARTMENT
SURVEY SECTION FIELD ENGINEERING DIVISION

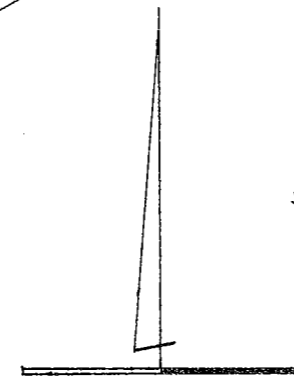

WESTERN AVE.

VERMONT AVE.

NADEAU ST.

AVALON BLVD.

92ND ST.

FLORENCE AVE.
CENTRAL AVE.
GAGE AVE.

CENTURY BLVD.

BROADWAY

SAN PEDRO ST.

COMPTON AVE.

HOLMES AVE.

WILMINGTON AVE.

WILLOWBROOK AVE.

120TH ST.

EL SEGUNDO BL.

ROSECRANS

IMPERIAL HWY.

ALAMEDA

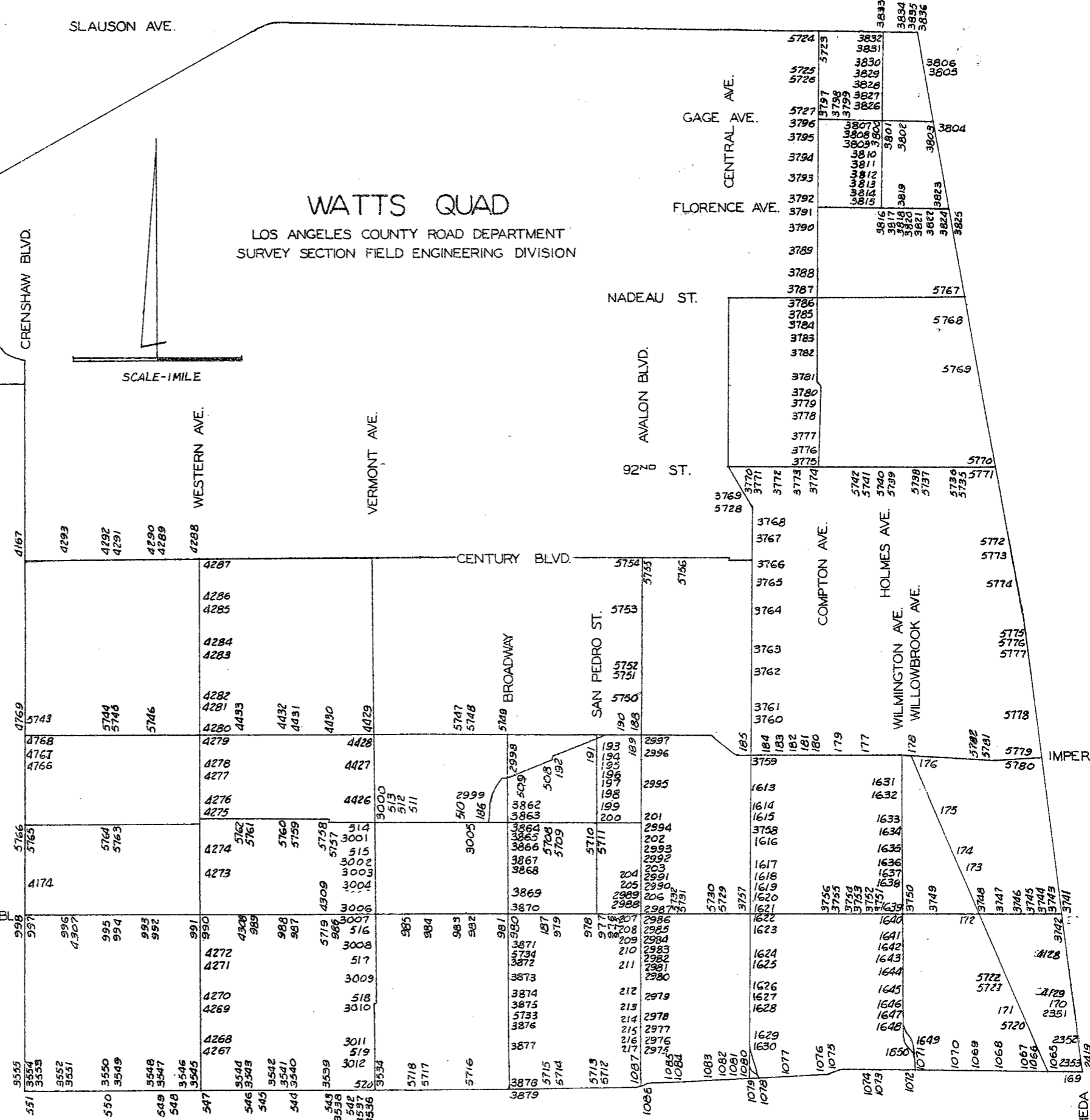

QUAD-YEAR	ELEV	DESCRIPTION (INCLUDE QUAD AND YEAR IN DESCRIPTION)	BM NUMBER
BASELINE (1955)	72.324	L+T E CB ALAMEDA ST 50FT± N C/L ROSECRANS BLVD	SY 169A
WATTS (1960)	72.259	L+T N CB ORIS ST 15FT± E OF E P/L WILLOWBROOK AVE	SY 171
WATTS (1960)	78.787	L+SPK 14FT± N BCR @ OUT EL SEGUNDO BLVD + WILLOWBROOK AVE	SY 172
WATTS (1960)	80.996	BT SPK NR CTR CB RET @ NE CAR WILLOWBROOK AVE + 124TH ST	SY 173
WATTS (1960)	82.706	BT SPK S CB 13FT± E BCR @ SE COR WILLOWBROOK AVE + 122ND ST	SY 174
WATTS (1960)	86.698	BT SPK N CB 119TH ST 60FT± E C/L WILLOWBROOK AVE	SY 175
WATTS (1960)	92.147	L+T S CB 12FT± E BCR 40FT± S C/L IMPERIAL HWY + 50FT± E C/L WILMINGTON AVE	SY 176A
WATTS (1960)	93.805	FLT HD SPK S CB 40FT± S C/L IMPERIAL HWY @ C/L PROD GRANDEE AVE	SY 177A
WATTS (1960)	94.458	L+T S CB 1FT± W BCR @ SW COR IMPERIAL HWY + WILLOWBROOK AVE 40FT± S + 38FT± W C/L INT	SY 178B
WATTS (1960)	93.293	LACE MON @ C/L IMPERIAL HWY 5FT± W CB LINE PROD COMPTON AVE N	SY 179A
WATTS (1960)	94.220	L+BN S CB 1FT± W BCR 40FT± S C/L IMPERIAL HWY + 36FT± W C/L ANTWERP AVE	SY 180A
WATTS (1960)	93.865	L+BN S CB 3FT± W BCR 40FT± S C/L IMPERIAL HWY + 40FT± W C/L SUCCESS AVE	SY 181A
WATTS (1960)	94.386	L+BN S CB 3FT± W BCR 40FT± S C/L IMPERIAL HWY + 35FT± W C/L PARMELEE AVE	SY 182A
WATTS (1960)	95.371	L+BN S CB 3FT± W BCR 40FT± S C/L IMPERIAL HWY + 36FT± W C/L SLATER ST	SY 183A
WATTS (1960)	96.036	L+BN S CB 1FT± E BCR 40FT± S C/L IMPERIAL HWY + 35FT± W C/L ALVARO ST	SY 184A
WATTS (1960)	173.260	RDBM TAG W CB 1FT± S BCR @ NW COR 120TH ST + ATHENS WAY S BARREL 45FT± N + 23FT± W C/L INT	SY 186A
WATTS (1960)	134.979	RDBM TAG N CB 1FT± W BCR @ NW COR EL SEGUNDO BLVD + MAIN ST 66FT± W + 40FT± N C/L INT	SY 187A
WATTS (1960)	110.898	RDBM TAG W CB 1FT S BCR 61FT± S + 30FT± W C/L INT IMPERIAL HWY + AVALON BLVD	SY 188A
WATTS (1960)	123.549	SPK W CB 4FT± S BCR @ SW COR SAN PEDRO ST + LANZIT AVE	SY 191
WATTS (1960)	135.186	L+T W CB MAIN ST ON C/L PROD LANZIT AVE S BARREL	SY 192A
WATTS (1960)	122.715	L+T W CB SAN PEDRO ST ON C/L PROD 115TH ST	SY 193
WATTS (1960)	118.127	SPK 5FT± N BCR @ NE COR 116TH ST + SAN PEDRO ST	SY 194
WATTS (1960)	119.989	L+T 1FT± N BCR @ NW COR 116TH PL + SAN PEDRO ST	SY 195

QUAD-YEAR	ELEV	DESCRIPTION (INCLUDE QUAD AND YEAR IN DESCRIPTION)	BM NUMBER
WATTS (1960)	122.899	L+SPK 1FT± S BCR @ SE COR 117TH ST + SAN PEDRO ST	SY 196
WATTS (1960)	123.397	L+SPK 5FT± N BCR @ NE COR 118TH ST + SAN PEDRO ST	SY 197
WATTS (1960)	125.804	L+SPK 5FT± N BCR @ NE COR 118TH PL + SAN PEDRO ST	SY 198
WATTS (1960)	128.302	L+T 2FT± N BCR @ NW COR 119TH ST + SAN PEDRO ST	SY 199
WATTS (1960)	119.156	L+SPK 9FT± N BCR @ NW COR 120TH ST + AVALON BLVD	SY 201
WATTS (1960)	119.675	L+T @ INT 121ST ST + AVALON BLVD	SY 202
WATTS (1960)	119.069	L+T @ INT 121ST PL + AVALON BLVD	SY 203
WATTS (1960)	114.994	L+T @ INT 127TH ST + AVALON BLVD	SY 206
WATTS (1960)	119.493	L+T CTR CB RET @ NW COR 129TH ST + AVALON BLVD	SY 208
WATTS (1960)	121.226	L+T CTR CB RET @ NW COR 130TH ST + AVALON BLVD	SY 209
WATTS (1960)	121.350	L+T CTR CB RET @ NW COR 131ST ST + AVALON BLVD	SY 210
WATTS (1960)	120.666	L+T 2FT± W BCR @ SW COR 132ND ST + AVALON BLVD	SY 211
WATTS (1960)	118.228	L+T 1FT± W BCR NW COR 135TH ST + AVALON BLVD	SY 212
WATTS (1960)	134.778	L+T E CB MAIN ST ON C/L PROD 116TH PL	SY 508
WATTS (1960)	152.576	L+T W CB BROADWAY ON C/L PROD 116TH PL	SY 509
WATTS (1960)	193.925	L+T N CB 3FT± W BCR @ NW COR FIGUEROA ST + 120TH ST	SY 510
WATTS (1960)	200.752	BT HD SET FOR LACE MON C/L INT HOOVER ST + 120TH ST	SY 511
WATTS (1960)	201.304	L+T 1FT± N BCR @ NE COR MENLO AVE + 120TH ST	SY 512
WATTS (1960)	200.360	L+T 1FT± N BCR @ NW COR AINSWORTH ST + 120TH ST	SY 513
WATTS (1960)	203.108	BT SPK 2FT± N BCR @ NW COR VERMONT AVE + 120TH ST	SY 514
WATTS (1960)	191.125	L+T 1FT± S BCR @ SW COR 123RD ST + VERMONT AVE	SY 515
WATTS (1960)	154.349	L+T C/L EL SEGUNDO BLVD ON C/L PROD VERMONT AVE	SY 516
WATTS (1960)	110.571	L+T 1FT± S BCR @ SW COR 132ND ST + VERMONT AVE	SY 517

QUAD-YEAR	ELEV	DESCRIPTION (INCLUDE QUAD AND YEAR IN DESCRIPTION)	BM NUMBER
BASELINE (1955)	46.904	L+T 16FT# W C/L NORMANDIE AVE 12FT# S C/L ROSECRANS BLVD	SY 544A
BASELINE (1955)	46.587	L+T 26FT# E C/L HALLDALE AVE + 12FT# S C/L ROSECRANS BLVD	SY 545A
BASELINE (1955)	46.204	L+T 26FT# E C/L DENKER AVE + 12FT# S C/L ROSECRANS BLVD	SY 546A
BASELINE (1955)	47.629	L+T 1FT# N BCR @ NE COR WESTERN AVE + ROSECRANS AVE 40FT# E + 65FT# N	SY 547B
BASELINE (1955)	54.390	FC BRASS PLATE NR N CB ROSECRANS AVE 122FT# E C/L CRENSHAW BLVD	SY 551A
WATTS (1960)	134.567	RDBM TAG N CB 33FT# W BCR @ NW COR EL SEGUNDO BLVD + SAN PEDRO ST 90FT# W + 40FT# N C/L INT	SY 977A
WATTS (1960)	135.142	L+T 2FT# E OF W END GAS STATION ISLAND 75FT# S C/L EL SEGUNDO BLVD + 115FT# W C/L SAN PEDRO ST	SY 978A
WATTS (1960)	147.613	RDBM TAG N CB 1FT# W BCR @ EL SEGUNDO BLVD + BROADWAY 40FT# N + 74FT# W C/L INT	SY 980B
WATTS (1960)	146.898	L+CT SPK 50FT# N C/L EL SEGUNDO BLVD + 15FT# W C/L BROADWAY	SY 981
WATTS (1960)	161.805	LACE MON IN WELL @ C/L INT FIGUEROA ST + EL SEGUNDO BLVD	SY 982A
WATTS (1960)	166.812	L+T SW COR CONC SLAB @ NW COR FIGUEROA ST + EL SEGUNDO BLVD 145FT# W + 38FT# N C/L INT	SY 983A
WATTS (1960)	169.879	L+BN SE COR CONC SLAB OF OIL WELL NO 2 PAC WEST OIL CORP 150FT# E HOOVER ST + 42FT# N C/L EL SEGUNDO BLVD	SY 984
WATTS (1960)	168.611	L+BN NE COR CONC BASE OIL DERRICK (INCA NO 1 GRANDY LEASE) @ SE COR MENLO AVE + EL SEGUNDO BLVD	SY 985
WATTS (1960)	138.947	L+T N CB 1FT# W BCR @ NW COR BUDLONG AVE + EL SEGUNDO BLVD 38FT# N + 45FT# W C/L INT	SY 986A
WATTS (1960)	124.610	RDBM TAG IN CB 1FT# N BCR @ NE COR 66FT# N EL SEGUNDO BLVD + 30FT# E NORMANDIE AVE	SY 987A
WATTS (1960)	123.048	RDBM TAG N CB 1FT# W BCR @ NW COR NORMANDIE AVE + EL SEGUNDO BLVD 38FT# N + 56FT# W C/L INT	SY 988F
WATTS (1960)	105.411	RDBM TAG IN CB 2FT# N BCR @ NW COR 68FT# N C/L EL SEGUNDO BLVD + 20FT# W DENKER AVE	SY 989A
WATTS (1960)	88.333	L+BN 25FT# N BCR @ NW COR EL SEGUNDO BLVD + WESTERN AVE 40FT# W + 100FT# N C/L INT	SY 990E
WATTS (1960)	83.489	L+BN 4FT# N BCR @ SW COR 41FT# W C/L WESTERN AVE + 67FT# S C/L EL SEGUNDO BLVD	SY 991A
WATTS (1960)	71.289	RDBM TAG IN CB 2FT# E BCR @ SE COR 43FT# S C/L EL SEGUNDO BLVD + 45FT# E C/L WILTON PL	SY 992A
WATTS (1960)	70.895	L+BN 1FT# W BCR @ SW COR 40FT# S C/L EL SEGUNDO BLVD + 60FT# W C/L WILTON PL	SY 993A
WATTS (1960)	61.082	L+BN S CB 43FT# E BCR @ SE COR 40FT# S C/L EL SEGUNDO BLVD + 106FT# E C/L VAN NESS AVE	SY 994A

QUAD-YEAR	ELEV	DESCRIPTION (INCLUDE QUAD AND YEAR IN DESCRIPTION)	BM NUMBER
WATTS (1960)	58.884	L+T 1FT± E BCR @ SW COR 40FT± S C/L EL SEGUNDO BLVD + 63FT± W C/L VAN NESS AVE	SY 995A
WATTS (1960)	48.272	RDBM TAG 1FT± N BCR @ NW COR 67FT± N C/L EL SEGUNDO BLVD + 18FT± W C/L WILKIE AVE (1000FT± E CRENSHAW BLVD)	SY 996A
BASELINE (1955)	51.486	FC MON 12IN 50FT± S C/L EL SEGUNDO BLVD 175FT± E C/L CRENSHAW BLVD ON W PROP LINE DOMINGUEZ FC CHANNEL	SY 997A
BASELINE (1955)	70.181	L+T NR CTR CB RET @ NE COR MONA AVE E BARREL + ROSECRANS AVE	SY 1065
BASELINE (1955)	70.256	L+T NR CTR CB RET @ NW COR WILLOWBROOK AVE W BARREL + ROSECRANS AVE	SY 1066A
BASELINE (1955)	70.005	L+T NR CTR CB RET @ NE COR ACACIA ST + ROSECRANS AVE	SY 1067A
BASELINE (1955)	71.553	L+N 5FT± W CB RET @ NE COR OLEANDER ST + ROSECRANS AVE	SY 1068A
BASELINE (1955)	72.565	L+T CTR CB RET NE COR ROSECRANS AVE + ARANBE AVE	SY 1069A
BASELINE (1955)	73.373	L+T CTR CB RET NE COR ROSECRANS AVE + MATTHISEN AVE	SY 1070A
BASELINE (1955)	75.548	L+T CTR CB RET NW COR WILMINGTON AVE + ROSECRANS AVE	SY 1071A
BASELINE (1955)	75.581	L+T CTR CB RET NW COR WILMINGTON AVE + ROSECRANS AVE	SY 1072A
BASELINE (1955)	76.319	CS MON IN WELL 38FT± N C/L ROSECRANS AVE + 38FT± W OF NW COR CONC BRIDGE OVER COMPTON CREEK 164FT± E C/L DWIGHT ST MKD (CS MON BM 21-2-1952 RE 63)	SY 1073A
BASELINE (1955)	77.797	L+BN N CB 2FT± E BCR @ NE COR ROSECRANS AVE + DWIGHT ST 38FT± N + 35FT± E C/L INT	SY 1074A
BASELINE (1955)	85.963	L+BN N CB 15FT± W BCR @ NW COR ROSECRANS AVE + TAJUATA AVE 36FT± N + 70FT± W C/L INT	SY 1075A
BASELINE (1955)	85.543	L+N E CB TAJUATA AVE 60FT± S C/L ROSECRANS AVE	SY 1076
BASELINE (1955)	100.824	CS MON IN WELL 44FT± N C/L ROSECRANS AVE 105FT± E C/L CENTRAL AVE 32FT± E BCR 4FT± N CB MKD (BM 21-3 1952 RE 63)	SY 1078A
BASELINE (1955)	102.993	L+T E EDGE CONC PVMT 14FT± E C/L CENTRAL AVE + 65FT± S C/L ROSECRANS AVE	SY 1079
BASELINE (1955)	103.475	L+BN N CB ROSECRANS AVE 2FT± W BCR + 44FT N C/L ROSECRANS AVE + 92FT± W C/L CENTRAL AVE	SY 1080
BASELINE (1955)	105.898	L+BN 4IN S BCR @ SE COR KEENE AVE+ ROSECRANS AVE	SY 1081
BASELINE (1955)	110.325	L+T S CB CENTRAL AVE SERVICE RD 1FT± E BCR 55FT± E C/L CAHITA AVE + 76FT± S C/L ROSECRANS AVE MKD (BM)	SY 1083
BASELINE (1955)	113.842	L+T NW COR HIGH TENSION LINE 65FT± S C/L ROSECRANS AVE 35FT± E C/L MCKINLEY AVE TOWER NO 25	SY 1084

QUAD-YEAR	ELEV	DESCRIPTION (INCLUDE QUAD AND YEAR IN DESCRIPTION)	BM NUMBER
BASELINE (1955)	114.526	L+BN N CB ROSECRANS AVE 1FT± 1FT± W BCR @ NW COR ROSECRANS AVE + STANFORD AVE 40FT± N + 52FT± W C/L INT	SY 1085A
BASELINE (1955)	118.101	L+T SW COR S GAS ISLAND 60FT N C/L ROSECRANS AVE + 100FT± E C/L AVALON BLVD	SY 1086B
BASELINE (1955)	118.234	L+T SW COR W GAS ISLAND 110FT± N C/L ROSECRANS AVE + 58FT± E C/L AVALON BLVD	SY 1087A
WATTS (1960)	93.321	SPK S CB 12FT± W BCR @ SW COR 118TH ST + CENTRAL AVE	SY 1613A
WATTS (1960)	92.199	SQ SPK S CB 119TH ST 5FT± E BCR CENTRAL AVE	SY 1614A
WATTS (1960)	91.524	L+SPK 3FT± E BCR @ SE COR 120TH ST + CENTRAL AVE	SY 1615A
WATTS (1960)	90.602	L+BN N END CATCH BASIN W CB CENTRAL AVE 75FT± S C/L 121ST PL	SY 1616
WATTS (1960)	90.255	L+BN 1FT± N BCR NE COR 124TH ST SERVICE ROAD + CENTRAL AVE	SY 1617
WATTS (1960)	90.041	L+BN 1FT± N BCR @ NE COR 126TH ST SERVICE ROAD + CENTRAL AVE	SY 1618
WATTS (1960)	89.815	L+BN 1FT± N BCR @ NE COR 127TH ST SERVICE ROAD +	SY 1619
WATTS (1960)	92.035	R D MCN IN WELL ON C/L CENTRAL AVE 30FT±N C/L EL SEGUNDO BLVD	SY 1621A
WATTS (1960)	93.185	L+BN E CB CENTRAL AVE W SERVICE ROAD 1FT± S CB RET @ N END ISLAND 55FT± W C/L + 500FT± S EL SEGUNDO BLVD	SY 1623
WATTS (1960)	94.906	L+BN W CB 5FT± N BCR @ NW COR 134TH ST + CENTRAL AVE SERVICE ROAD 80FT± W + 54FT± N C/L INT	SY 1626
WATTS (1960)	95.352	L+BN W CB 1FT± S BCR @ SW COR 134TH ST + CENTRAL AVE W SERVICE ROAD 80FT± W + 50FT± S C/L INT	SY 1627A
WATTS (1960)	101.490	L+BN E CB 2FT± N BCR @ NE COR CENTRAL AVE E SERVICE ROAD + 139TH ST 44FT N + 80FT± E C/L INT	SY 1629A
WATTS (1960)	101.836	L+BN E CB CENTRAL AVE (SERVICE RD) 2FT S BCR @ SE COR 139TH ST 80FT E + 67FT S C/L INT	SY 1630A
WATTS (1960)	91.573	L+BN S END CATCH BASIN @ NW COR WILMINGTON AVE + 117TH ST	SY 1631A
WATTS (1960)	88.926	L+SPK W CB WILMINGTON AVE 18FT± S C/L PROD 119TH ST	SY 1633
WATTS (1960)	88.538	L+BN S END CATCH BASIN @ NW COR WILMINGTON AVE + 120TH ST	SY 1634
WATTS (1960)	87.660	L+BN W CB WILMINGTON AVE 24FT± N C/L PROD 122ND ST	SY 1635
WATTS (1960)	85.600	L+T 23FT N BCR @ NE COR 124TH ST + WILMINGTON AVE	SY 1636A

QUAD-YEAR	ELEV	DESCRIPTION (INCLUDE QUAD AND YEAR IN DESCRIPTION)	BM NUMBER
WATTS (1960)	84.394	L+T 1FT± W BCR @ NW COR 126TH ST + WILMINGTON AVE	SY 1637A
WATTS (1960)	82.907	L+T CATCH BASIN @ SW COR EL SEGUNDO BLVD + WILMINGTON AVE	SY 1639
WATTS (1960)	82.913	R D MON IN WELL ON C/L INT EL SEGUNDO BLVD + WILMINGTON AVE	SY 1640
WATTS (1960)	81.562	L+SPK 6FT± E BCR @ NE COR 130TH ST + WILMINGTON AVE 15FT± N + 36FT± E C/L INT	SY 1641
WATTS (1960)	81.424	RDBM TAG W CB 4FT± N BCR @ NW COR 130TH ST + WILMINGTON AVE 38FT± W + 60FT N C/L INT	SY 1642
WATTS (1960)	80.729	L+SPK W END CATCH BASIN 20FT± W BCR @ NW COR 131ST ST + WILMINGTON AVE 48FT± W + 18FT± N C/L INT	SY 1643
WATTS (1960)	79.547	BT SPK W CB 1FT N BCR @ NW COR 133RD ST + WILMINGTON AVE 29FT± N + 28FT W C/L INT	SY 1644A
WATTS (1960)	79.300	L+BN 4FT± W CATCH BASIN @ NW COR 134TH PL + WILMINGTON AVE 18FT N + 57FT± W C/L INT	SY 1645
WATTS (1960)	77.681	L+BN CTR CB RET ISLAND @ NE COR STOCKWELL ST + WILMINGTON AVE 45FT± E + 25FT N C/L INT	SY 1646
WATTS (1960)	77.762	L+T E CB 1FT N BCR @ NE COR 137TH ST + WILMINGTON AVE 40FT± E + 50FT N C/L INT	SY 1647A
WATTS (1960)	77.549	L+T E CB 1FT± S BCR @ SE COR 137TH ST + WILMINGTON AVE 40FT± E + 63FT S C/L INT	SY 1648A
WATTS (1960)	77.052	L+SPK S CB 105FT W BCR @ SW COR WILMINGTON AVE + CRESSEY ST 18FT± S + 171FT± W C/L INT MKD (C 168)	SY 1649
WATTS (1960)	76.907	RDBM TAG N CB 3FT± W BCR @ NW COR WILMINGTON AVE + CRESSEY ST 18FT± N + 65FT± W C/L INT	SY 1650A
BASELINE (1955)	73.442	L+T E CB ALAMEDA ST 33FT± S OF N CB ORIS ST PROD	SY 2351
BASELINE (1955)	71.249	L+T E CB ALAMEDA ST ON C/L PROD MEALY ST	SY 2352
BASELINE (1955)	72.180	L+T E CB 2FT± S BCR @ SE COR ALAMEDA ST + ROSECRANS BLVD	SY 2353
BASELINE (1955)	70.370	L+T CTR CB RET @ SE COR ROSECRANS AVE + ALAMEDA ST E BARREL	SY 2419
WATTS (1960)	121.326	L+BN IN E CB 4FT± N BCR @ ^E NW COR 139TH ST + AVALON BLVD	SY 2975
WATTS (1960)	121.350	L+BN IN W CB 2FT± N BCR @ NW COR 139TH ST + AVALON BLVD	SY 2976
WATTS (1960)	120.888	LA DEPT OF PUBLIC WORKS BR CAP IN CONC 2FT± E OF E CB @ BCR NE COR 138TH ST + AVALON BLVD MKD (46H)	SY 2977
WATTS (1960)	120.052	L+BN IN E CB 2FT± N BCR @ NE COR 137TH ST + AVALON BLVD	SY 2978
WATTS (1960)	118.318	L+T IN E CB 1FT± S BCR + END OF CB @ NE COR 135TH ST + AVALON BLVD	SY 2979

QUAD-YEAR	ELEV	DESCRIPTION (INCLUDE QUAD AND YEAR IN DESCRIPTION)	BM NUMBER
WATTS (1960)	119.515	L+BN W CB IN FRONT HSE NO 13301 AVALON BLVD OPP N EDGE OF WK	SY 2980
WATTS (1960)	119.683	CS MON @ C/L INT AVALON BLVD + 132ND ST (USE N EDGE BR CAP)	SY 2981
WATTS (1960)	115.306	CS MON @ C/L INT EL SEGUNDO BLVD + AVALON BLVD (SW EDGE BR CAP) MKD (RD 329)	SY 2986
WATTS (1960)	115.085	L+T W CB 8FT± N BCR @ NW COR AVALON BLVD + EL	SY 2987
WATTS (1960)	115.829	L+T 2FT± E OF W END OF CONC HDWL TO CULV 5FT± S + 90FT± E OF C/L INT AVALON BLVD + 124TH ST	SY 2990
WATTS (1960)	116.787	L+SPK E CB E SERVICE ROAD 2FT± S BCR @ SE COR AVALON BLVD SERVICE ROAD + 122ND ST	SY 2991
WATTS (1960)	119.574	L+SPK W CB PKWY BETWEEN AVALON BLVD + SERVICE ROAD 5FT± S + 35FT± E C/L INT AVALON BLVD + 121ST ST MKD (TA 55)	SY 2992
WATTS (1960)	119.520	L+T N CB 4FT± E BCR @ NE COR 121ST ST + AVALON BLVD	SY 2993
WATTS (1960)	119.421	L+BN W CB 9FT± S BCR @ SW COR AVALON BLVD + 120TH ST	SY 2994
WATTS (1960)	117.900	L+SPK @ C/L INT AVALON BLVD + 118TH ST	SY 2995
WATTS (1960)	116.693	L+SPK @ C/L INT AVALON BLVD + 116TH ST	SY 2996
WATTS (1960)	109.262	LACE MON IN WELL @ C/L INT IMPERIAL HWY + AVALON BLVD (N OF TWO MON 4FT± APART)	SY 2997A
WATTS (1960)	154.077	SPK N CB 117TH ST 2FT± E OF END OF CB 145FT± W OF W CB BROADWAY	SY 2998
WATTS (1960)	168.120	L+T S CB 3FT± E OF END OF CB @ SE COR 118TH PL + ATHENS WAY	SY 2999
WATTS (1960)	202.252	CS TAG E CB 6FT± N BCR @ NE COR VERMONT AVE E BARREL + 120TH ST 25FT± E + 55FT± N C/L INT	SY 3000A
WATTS (1960)	187.008	SPK E CB 5FT N BCR @ NE COR W 124TH ST + VERMONT AVE	SY 3002
WATTS (1960)	184.460	LACE MON C/L PROD 124TH ST 25FT± W OF E CB LINE VERMONT AVE	SY 3003
WATTS (1960)	163.774	SPK E CB 4FT± N BCR @ NE COR 125TH ST + VERMONT AVE	SY 3004
WATTS (1960)	173.215	HEX DRILL STEEL W/LACE MON COVER @ C/L INT 120TH ST + ATHENS WAY	SY 3005A
WATTS (1960)	154.050	SPK E CB 2FT± S BCR @ SE COR EL SEGUNDO BLVD + VERMONT AVE 39FT± S + 70FT± E C/L INT	SY 3006A
WATTS (1960)	154.199	LACE MON C/L EL SEGUNDO BLVD 25FT± W OF E CB LINE VERMONT AVE	SY 3007A
WATTS (1960)	129.832	L+BR N CB 2FT± E BCR @ NW COR 130TH ST + VERMONT AVE W BARREL	SY 3008
WATTS (1960)	98.728	L+T W CB VERMONT AVE W BARREL IN FRONT OF HSE NO 13321 OPP S CB LINE PROD W OF 133RD ST	SY 3009

QUAD-YEAR	ELEV	DESCRIPTION (INCLUDE QUAD AND YEAR IN DESCRIPTION)	BM NUMBER
WATTS (1960)	85.433	L+T N CB 1FT± W BCR @ NW COR 135TH ST + VERMONT AVE W BARREL	SY 3010
WATTS (1960)	75.798	L+BN W CB VERMONT AVE W BARREL OPP N P/L PROD E OF HSE NO 13713 800FT± S 135TH ST	SY 3011
WATTS (1960)	65.655	L+BN W CB VERMONT AVE 2FT± S BCR OF DRWY TO (MCNTEREY CLUB) BLDG NO 13927	SY 3012
BASELINE (1955)	61.651	LACE MON C/L INT ROSECRANS AVE + VERMONT AVE E BARREL MKD (TRAV STA WATTS B 12 1946)	SY 3534
BASELINE (1955)	60.720	L+T W CB 5FT± S BCR @ SW COR VERMONT AVE + ROSECRANS AVE 60FT± S C/L ROSECRANS + 18FT± W OF W BARREL	SY 3536A
BASELINE (1955)	55.817	L+T E CB BERENDO AVE 5FT± S OF END OF CB 60FT± S C/L ROSECRANS AVE	SY 3537A
BASELINE (1955)	52.321	L+BR S CB ROSECRANS AVE 5FT E OF END OF CB @ W END CATCH BASIN 25FT S + 60FT E C/L INT BUDLONG AVE + ROSECRANS AVE MKD (BM)	SY 3538A
BASELINE (1955)	51.802	L+BR W CB BUDLONG AVE 12FT S END OF CB 18FT W + 60FT S C/L INT OF BUDLONG AVE + ROSECRANS AVE MKD (BM)	SY 3539A
BASELINE (1955)	47.621	L+BR E CB NORMANDIE AVE 10FT S OF END CB 30FT E + 60FT S C/L INT NORMANDIE AVE + ROSECRANS AVE MKD (BM)	SY 3540A
BASELINE (1955)	46.417	CS MON 54FT± S C/L ROSECRANS AVE + 26FT± W C/L NORMANDIE AVE MKD (BM 21 8 1952 RE 63)	SY 3541A
BASELINE (1955)	47.513	L+T NW COR CONC WK TO COURT 50FT S C/L ROSECRANS AVE 65FT± E C/L HALLDALE AVE	SY 3542A
BASELINE (1955)	47.695	L+T SE COR CONC BLDG NO 1639 ROSECRANS AVE 55FT± N C/L ROSECRANS AVE	SY 3544
BASELINE (1955)	47.350	L+BN W CB 4FT± S BCR 35FT± W C/L WESTERN AVE + 65FT± N C/L ROSECRANS AVE MKD (BM)	SY 3545A
BASELINE (1955)	45.201	L+T S CB 1FT± E BCR 40FT± E + 40FT± S C/L INT ROSECRANS AVE + GRAMERCY PL	SY 3547A
BASELINE (1955)	44.895	L+T W CB GRAMERCY PL 1FT S OF BCR 18FT W + 60FT S C/L INT ROSECRANS AVE + GRAMERCY PL	SY 3548A
BASELINE (1955)	45.343	RDBM TAG 7FT E BCR 40FT S + 75FT E C/L INT ROSECRANS AVE + VAN NESS AVE (IN S CB)	SY 3549A
BASELINE (1955)	46.484	RDBM TAG W CB VAN NESS AVE 5FT N BCR 30FT W + 68FT N C/L INT ROSECRANS AVE + VAN NESS AVE	SY 3550A
BASELINE (1955)	48.600	L+T E CB 1FT± S BCR @ SE COR WADKINS AVE + ROSECRANS AVE	SY 3553A
BASELINE (1955)	50.585	CS MON ON C/L CRENSHAW BLVD 45FT± N C/L ROSECRANS AVE	SY 3555
BASELINE (1955)	80.251	BR CAP @ S END W CONC BANNISTER @ MAIN ENT TO THE (FRANCIS WILLARD SCHOOL) 114FT± E C/L ALAMEDA ST + 98FT± S C/L EL SEGUNDO BLVD MKD (W 615 1941)	SY 3741A
BASELINE (1955)	75.919	CS MON 27FT± E C/L ALAMEDA ST + 3FT± S C/L EL SEGUNDO BLVD	SY 3742A

QUAD-YEAR	ELEV	DESCRIPTION (INCLUDE QUAD AND YEAR IN DESCRIPTION)	BM NUMBER
BASELINE (1955)	77.262	L+BN 2FT± W BCR @ SW COR ALAMEDA ST + EL SEGUNDO BLVD	SY 3743A
WATTS (1960)	77.772	L+SPK @ W COR ENT TO BLDG NO 2637 EL SEGUNDO BLVD 50FT± N C/L + 171FT± W C/L ALAMEDA ST	SY 3744
WATTS (1960)	76.774	L+T S EDGE CONC WK TO CHURCH BLDG NO 12726 MONA BLVD 2FT± W 1ST STEP OF PORCH @ NE COR MONA BLVD + EL SEGUNDO BLVD 33FT± E + 51FT± N C/L INT	SY 3745
WATTS (1960)	76.295	L+BN 4FT± W OF END OF CB @ MONA OUT MONA BLVD + EL SEGUNDO BLVD	SY 3746
WATTS (1960)	79.022	L+T W EDGE CONC DRWY TO HSE NO 2411 EL SEGUNDO BLVD 51FT± N C/L	SY 3747
WATTS (1960)	78.764	L+T 3FT± S BCR @ NW COR EL OUT EL SEGUNDO BLVD + WILLOWBROOK AVE	SY 3748
WATTS (1960)	80.242	SPK W CB PRIVATE ST N FROM EL SEGUNDO BLVD BETWEEN HSES NO 2101 + 2109 EL SEGUNDO BLVD 20FT± W CTR OF PRIVATE RD + 38FT± N C/L EL SEGUNDO BLVD (1100FT± E WILMINGTON AVE) MKD (BM C 184)	SY 3749
WATTS (1960)	82.747	L+T 4FT± E BCR @ NE COR WILMINGTON AVE + EL SEGUNDO BLVD 24FT± N + 35FT± E C/L INT	SY 3750
WATTS (1960)	83.332	L+T 4FT± W BCR @ NW COR GRANDEE AVE + EL SEGUNDO BLVD	SY 3751
WATTS (1960)	82.865	L+T S CB EL SEGUNDO BLVD 3FT± NE PP NO 613697E 535FT± W C/L GRANDEE AVE	SY 3752
WATTS (1960)	82.853	L+T N CB EL SEGUNDO BLVD 11FT± S OF PP NO 62133E 538FT± W C/L GRANDEE AVE	SY 3753
WATTS (1960)	82.357	L+BN S CB EL SEGUNDO BLVD 3FT± E BCR @ E END SCHOOL PARKING AREA OPP BLDGS NO 1433 + 1435 EL SEGUNDO BLVD	SY 3754
WATTS (1960)	81.941	L+BN S CB EL SEGUNDO BLVD 2FT± E CATCH BASIN FRONT OF EL SEGUNDO SCHOOL 390FT± E C/L COMPTON CREEK	SY 3756A
WATTS (1960)	92.450	BN 2FT± S BCR @ SW COR CENTRAL AVE + EL SEGUNDO BLVD	SY 3757
WATTS (1960)	91.386	L+BN 2FT± N BCR @ NE COR 121ST ST + CENTRAL AVE	SY 3758
WATTS (1960)	98.395	SQ HD SPK @ ANGLE PT OF WINGWALL TOBRIDGE OVER COMPTON CREEK 50FT± E C/L CENTRAL AVE + 45FT± S BCR @ SE COR IMPERIAL HWY + CENTRAL AVE	SY 3759
WATTS (1960)	99.251	WIRE SPK IN E CB CENTRAL AVE 6FT S BCR @ SE COR 112TH ST 38FT E + 50FT S C/L INT	SY 3761A
WATTS (1960)	104.486	L+BN E CB CENTRAL AVE 38FT± E C/L ON C/L PROD 108TH ST	SY 3763A
WATTS (1960)	107.175	SQ HD SPK 8FT± E BCR @ SE COR 105TH ST + CENTRAL AVE	SY 3764
WATTS (1960)	111.849	SPK E CB CENTRAL AVE 5FT N BCR @ NE COR 103RD ST 38FT E + 55FT N C/L INT	SY 3765A
WATTS (1960)	114.665	L+BN N CB CENTURY BLVD 1FT± W BCR @ NE COR CENTURY BLVD + CENTRAL AVE	SY 3766

QUAD-YEAR	ELEV	DESCRIPTION (INCLUDE QUAD AND YEAR IN DESCRIPTION)	BM NUMBER
WATTS (1960)	118.107	L+T W SIDE OF CONC BASE SW LEG OF HIGH TENSION TOWER NO 1 ON E SIDE CENTRAL AVE 50FT± N BLDG NO 9808	SY 3767
WATTS (1960)	119.669	L+SPK NW SIDE OF CONC BASE NW LEG OF HIGH TENSION TOWER NO 267D1 ON E SIDE CENTRAL AVE 1ST TOWER S OF GOLDEN AVE	SY 3768
WATTS (1960)	119.165	L+BN @ S END OF ISLAND 65FT± N C/L PROD 95TH ST + 4FT± E C/L PRCD CENTRAL AVE	SY 3769
WATTS (1960)	121.286	L+SPK 10FT± N BCR @ NW COR 92ND ST + HOOPER AVE @ SW COR OF CATCH BASIN	SY 3770
WATTS (1960)	121.293	ROUND HD SPK 4FT± E BCR @ NE COR 92ND ST + HOOPER AVE	SY 3771
WATTS (1960)	121.753	ROUND HD SPK N CB 92ND ST 1FT± W C/L PROD BAIRD AVE	SY 3772
WATTS (1960)	121.614	L+T N CB 92ND ST ON C/L PROD PARMELEE AVE	SY 3773
WATTS (1960)	121.859	ROUND HD SPK 7FT± W BCR @ NW COR 92ND ST + COMPTON AVE	SY 3774
WATTS (1960)	121.704	ROUND HD SPK 1FT± N BCR @ NE COR 92ND ST + COMPTON AVE	SY 3775
WATTS (1960)	122.921	L+T 2FT± S BCR @ SE COR 91ST ST + COMPTON AVE	SY 3776
WATTS (1960)	124.415	L+T 1FT± N BCR @ NE COR 90TH ST + COMPTON AVE	SY 3777
WATTS (1960)	126.585	ROUND HD SPK W CB COMPTON AVE 1FT± S C/L PROD 88TH ST	SY 3778
WATTS (1960)	127.911	L+T W CB COMPTON AVE 15FT± S C/L PROD 87TH ST	SY 3779
WATTS (1960)	129.013	L+T N CB FIRESTONE BLVD C/L PROD COMPTON AVE FROM THE S	SY 3780
WATTS (1960)	129.578	L+T 2FT± W BCR @ NW COR FIRESTONE BLVD + COMPTON AVE	SY 3781
WATTS (1960)	131.532	L+BN 15FT± E BCR @ SE COR 84TH ST + COMPTON AVE	SY 3782
WATTS (1960)	132.996	L+BN 2FT± N BCR @ NE COR 83RD ST + COMPTON AVE	SY 3783
WATTS (1960)	135.483	L+BN 15FT± E BCR @ NE COR 82ND + COMPTON AVE	SY 3784
WATTS (1960)	137.192	L+SPK 15FT± S BCR @ SE COR 80TH ST + COMPTON AVE	SY 3785
WATTS (1960)	138.153	L+BN 30FT S BCR @ SE COR NADEAU ST + COMPTON AVE	SY 3786
WATTS (1960)	138.810	L+BN 2FT S BCR @ NE COR NADEAU ST + COMPTON AVE	SY 3787
WATTS (1960)	140.894	L+T 3FT N BCR @ NE COR 77TH PL + COMPTON AVE	SY 3788

QUAD-YEAR	ELEV	DESCRIPTION (INCLUDE QUAD AND YEAR IN DESCRIPTION)	BM NUMBER
WATTS (1960)	143.464	L+T 1FT N BCR @ NE COR 76TH PL + COMPTON AVE	SY 3789
WATTS (1960)	146.156	L+T 13FT N BCR @ NE COR 75TH ST + COMPTON AVE	SY 3790
WATTS (1960)	149.464	L+BN 1FT± E BCR @ SE COR FLORENCE AVE + COMPTON AVE	SY 3791
WATTS (1960)	149.431	L+BN CTR CB RET NW COR FLORENCE AVE + COMPTON AV	SY 3792
WATTS (1960)	149.464	L+T 1FT± N BCR @ NE COR 70TH ST + COMPTON AVE	SY 3793
WATTS (1960)	155.134	L+T 1FT± N BCR @ NE COR 68TH ST + COMPTON AVE	SY 3794
WATTS (1960)	158.584	L+T 3FT± N BCR @ NE COR 66TH ST + COMPTON AVE	SY 3795
WATTS (1960)	160.615	L+BN 1FT± E BCR @ SE COR GAGE AVE + COMPTON AVE	SY 3796
WATTS (1960)	164.149	L+T CTR CB RET SE COR MIRAMONTE BLVD + GAGE AVE	SY 3798
WATTS (1960)	167.622	L+BN S CB GAGE AVE 5FT± E OF E RAIL PERR LB LINE	SY 3799
WATTS (1960)	165.412	L+T CTR CB RET SW COR HOLMES AVE + GAGE AVE	SY 3800
WATTS (1960)	165.253	L+T CTR CB RET SE COR HOLMES AVE + GAGE AVE	SY 3801
WATTS (1960)	167.274	L+T 5FT± W CTR CB RET @ SW COR WILMINGTON AVE + GAGE AVE	SY 3802
BASELINE (1955)	166.892	L+BN CTR CB RET NW COR ALAMEDA ST + GAGE AVE	SY 3803A
BASELINE (1955)	167.272	L+T 20FT N C/L PROD GAGE AVE ON THE E CB OF ALAMEDA ST	SY 3804A
BASELINE (1955)	175.892	CS MON 13FT± N FROM THE MOST N PE TRACK RANDOLPH ST + 12FT W FROM MOST W SP RAIL ON ALAMEDA ST	SY 3805A
BASELINE (1955)	179.197	DISC IN S WALL 2FT± E OF THE SW COR + 3FT± ABOVE WK @ THE INT ALAMEDA ST + RANDOLPH ST 8FT± E OF E CB + 8FT± N OF N CB	SY 3806A
WATTS (1960)	164.539	L+T CTR CB RET SW COR E 64TH ST + HOLMES AVE	SY 3807
WATTS (1960)	162.916	L+T CTR CB RET NE COR 65TH ST + HOLMES AVE	SY 3808
WATTS (1960)	161.822	L+T 1FT S OF SW COR BLDG @ NO 6526 HOLMES AVE ON NE COR 66TH ST + HOLMES AVE	SY 3809
WATTS (1960)	159.748	L+T CTR CB RET SE COR 67TH ST + HOLMES AVE	SY 3810
WATTS (1960)	159.198	L+T NW COR OF RETAINING WALL OF HSE NO 6802 HOLMES AVE @ SE COR 68TH ST + HOLMES AVE	SY 3811
WATTS (1960)	157.127	L+BN N END 1ST STEP OF WK TO HSE NO 6822 HOLMES AVE NE COR 69TH ST + HOLMES AVE	SY 3812

QUAD-YEAR	ELEV	DESCRIPTION (INCLUDE QUAD AND YEAR IN DESCRIPTION)	BM NUMBER
WATTS (1960)	154.991	L+BN 4FT± E BCR @ SE COR 70TH ST + HOLMES AVE	SY 3813
WATTS (1960)	153.532	L+BN 6FT± N BCR @ NE COR 71ST ST + HOLMES AVE	SY 3814
WATTS (1960)	153.120	L+BN 8FT± N BCR @ NE COR FLORENCE AVE + HOLMES AVE	SY 3815
WATTS (1960)	152.735	L+T S CB FLORENCE AVE C/L PROD HOLMES AVE FROM THE N	SY 3816
WATTS (1960)	152.880	L+T N CB 17FT± W C/L PROD WHITSET AVE + 35FT± N C/L FLORENCE AVE	SY 3817
WATTS (1960)	152.588	L+T N CB FLORENCE AVE C/L PROD WALNUT DR	SY 3818
WATTS (1960)	152.442	L+T 1FT± W BCR @ NW COR WILMINGTON + FLORENCE AVE	SY 3819
WATTS (1960)	152.044	L+T 1FT± E BCR @ NW COR WILSON AVE + FLORENCE AVE	SY 3821
WATTS (1960)	151.838	L+SPK N CB FLORENCE AVE 27FT± W C/L PROD CROCKET BLVD	SY 3822
BASELINE (1955)	154.451	L+BN 1FT± W CB RET NW COR ALAMEDA ST + FLORENCE AVE	SY 3823A
BASELINE (1955)	154.050	CS MON 1FT± N C/L FLORENCE AVE W SIDE SPRR TRACKS + 6FT± W OF E CB LINE ALAMEDA ST	SY 3824A
BASELINE (1955)	157.633	CS MON SW COR MILLER GASKET CO BLDG 2FT± ABOVE GROUND + 3FT± N OF THE BLDG COR 86FT± E OF E CB ALAMEDA ST + 1FT± N OF THE N CB OF FLORENCE AVE	SY 3825A
WATTS (1960)	166.890	L+T 2FT± S BCR @ SE COR 63TD ST + HOLMES AVE	SY 3826
WATTS (1960)	168.567	L+BN 5FT± E BCR @ NE COR 62ND ST + HOLMES AVE	SY 3827
WATTS (1960)	170.123	L+BN 6FT± N BCR @ NE COR 61ST ST + HOLMES AVE	SY 3828
WATTS (1960)	171.970	L+T 1FT N BCR @ NE COR 60TH ST + HOLMES AVE	SY 3829
WATTS (1960)	175.687	L+BN 1FT± S BCR @ SE COR 58TH PL + HOLMES AVE	SY 3831
WATTS (1960)	175.923	L+BN 4FT± S BCR @ SW COR SLAUSON AVE + HOLMES AVE	SY 3832A
WATTS (1960)	176.038	L+BN 3FT± E BCR @ SE COR SLAUSON AVE + HOLMES AVE	SY 3833A
WATTS (1960)	178.960	L+BN 1FT± E BCR @ SE COR WILMINGTON AVE + SLAUSON AVE	SY 3834A
BASELINE (1955)	179.881	L+BN 2FT± E BCR @ SW COR SLAUSON AVE + ALAMEDA ST	SY 3835
BASELINE (1955)	179.431	CS MON C/L SLAUSON AVE 14FT± W OF W RAIL SPRR 20FT± E C/L ALAMEDA ST	SY 3836
WATTS (1960)	157.089	L+T 3FT± S BCR @ SE COR 118TH PL + BROADWAY	SY 3862

QUAD-YEAR	ELEV	DESCRIPTION (INCLUDE QUAD AND YEAR IN DESCRIPTION)	BM NUMBER
WATTS (1960)	158.584	L+T 4FT± NW CTR CB RET SW COR 120TH ST + BROADWAY	SY 3863
WATTS (1960)	158.270	L+BR 1FT± S BCR @ SE COR 120TH ST + BROADWAY	SY 3864
WATTS (1960)	164.161	L+BR 2FT± N BCR @ NE COR 121ST ST + BROADWAY	SY 3865
WATTS (1960)	178.709	L+SPK 6FT± S BCR @ SW COR 122ND ST + BROADWAY	SY 3866
WATTS (1960)	173.516	L+T 2FT N BCR @ NE COR 124TH ST + BROADWAY	SY 3867
WATTS (1960)	173.249	L+T 8FT± W BCR @ NW COR 124TH ST + BROADWAY	SY 3868
WATTS (1960)	154.939	L+T W CB BROADWAY 20FT± N C/L PROD 127TH ST	SY 3869
WATTS (1960)	144.347	L+PK CONC 14FT± E C/L BROADWAY 21FT± W PP NO 400683E 5TH PP S OF EL SEGUNDO BLVD	SY 3871
WATTS (1960)	134.041	L+BN E CB BROADWAY 18FT± S BCR @ SE COR 131ST ST 40FT± E + 82FT± S C/L INT	SY 3872A
WATTS (1960)	116.138	L+N N END GAS STATION ISLAND 40FT± S C/L 133RD ST + 51FT± W C/L BROADWAY	SY 3873
WATTS (1960)	116.994	L+SPK CONC PVMT 14FT± W C/L INT BROADWAY + 135TH ST	SY 3874
WATTS (1960)	118.933	L+BN NE COR OF METER BOX 50FT± W C/L BROADWAY + 20FT± S C/L 135TH ST	SY 3875
WATTS (1960)	118.307	BR CAP LIN DN UNION OIL CO 50FT± W C/L BROADWAY 524FT± S C/L 135TH ST MKD (LS 1968)	SY 3876
WATTS (1960)	119.456	L+BN W CB 22FT± N CTR OF DRWY TO EMPLOYEES PRKNG LOT OF UNION OIL REFINERY 38FT± W C/L BROADWAY + 1553FT± N ROSECRANS AVE	SY 3877A
BASELINE (1955)	116.755	L+BN S EDGE CONC BASE OF SIGNAL LIGHTS 30FT N C/L ROSECRANS AVE + 55FT± W C/L BROADWAY	SY 3878A
BASELINE (1955)	OUT	RAM SET NW COR OF CONC BASE OF STOP SIGN 35FT± E C/L BROADWAY 70FT± S C/L ROSECRANS AVE	SY 3879A
BASELINE (1955)	73.213	DISC NW COR CONC PILLAR OF CONSOLIDATED ROCK PRODUCTS 100FT± E SPRR TRACK 0.15MI± S CRIS ST ON ALAMEDA ST	SY 4129A
BASELINE (1955)	167.573	CS MON IN WELL 2FT± BACK OF CB @ APPROX CTR OF SW CB RET CRENSHAW BLVD + CENTURY BLVD MKD (BM 27-68 1953 RE 63)	SY 4167
BASELINE (1955)	52.323	FC MON 12IN DN 32FT± N C/L PERR TRACKS 5FT± S IP MARKER 160FT± E C/L CRENSHAW BLVD MKD (BM 114-56 R/W 114-39 1948)	SY 4174
WATTS (1960)	147.915	RDBM L+TAG 1FT± S BCR @ SE COR 122ND ST + WESTERN AVE 40FT ST + 40FT E C/L INT	SY 4274
WATTS (1960)	156.283	BR CAP IN SW ABUT CONC BRIDGE 36FT± W C/L WESTERN AVE 300FT± N 120TH ST MKD (DEPT OF W+P CITY OF LA BM)	SY 4275

QUAD-YEAR	ELEV	DESCRIPTION (INCLUDE QUAD AND YEAR IN DESCRIPTION)	BM NUMBER
WATTS (1960)	156.425	BR CAP IN NW ABUT OF CONC BRIDGE 36FT± W C/L WESTERN AVE 400FT± N 120TH ST MKD (DEPT OF W+ P CITY OF LA BM)	SY 4276
WATTS (1960)	198.163	L+T NE COR 3FT CONC WK S SIDE BLDG NO 11613 WESTERN AVE 51FT± W C/L WESTERN AVE 1000FT± S IMPERIAL HWY	SY 4277
WATTS (1960)	191.075	OUT L+T SE COR CONC DRWY HSE NO 11603 WESTERN AVE 36FT± W C/L WESTERN AVE 900FT± S C/L IMPERIAL HWY	SY 4278
WATTS (1960)	211.734	OUT RDBM L+TAG 1FT± S BCR @ SW COR IMPERIAL HWY + WESTERN AVE 40FT± W + 75FT S C/L INT	SY 4279
WATTS (1960)	202.074	RDBM L+TAG 1FT± N BCR @ NE COR IMPERIAL HWY + WESTERN AVE 54FT± E + 79FT N C/L INT	SY 4280
WATTS (1960)	207.360	L+T 28FT± S BCR @ SE COR 111TH ST + WESTERN AVE 54FT± E + 74FT± S C/L INT	SY 4281
WATTS (1960)	207.366	L+BN 38FT± N BCR @ NE COR 111TH ST + WESTERN AVE 38FT± E + 81FT± N C/L INT	SY 4282
WATTS (1960)	203.315	L+BR 2FT± S BCR @ SW COR 108TH ST + WESTERN AVE 58FT± S + 38FT± W C/L INT	SY 4283
WATTS (1960)	205.289	L+SPK @ BCR @ NW COR 108TH ST + WESTERN AVE 38FT± W + 77FT± N C/L INT MKD (E 9A)	SY 4284
WATTS (1960)	238.084	ROUND HD SPK 10FT± N BCR @ NE COR 104TH ST + WESTERN AVE 36FT± E + 29FT± N C/L INT MKD (BBA)	SY 4285
WATTS (1960)	237 .877	L+T 5FT± N BCR @ NW COR 104TH ST + WESTERN AVE 54FT± N + 35FT± W C/L INT	SY 4286
WATTS (1960)	237.033	LACE BR CAP @ C/L INT WESTERN AVE + CENTURY BLVD	SY 4287
WATTS (1960)	236.935	L+FLT NAIL 3FT± S BCR @ NW COR WESTERN AVE + CENTURY BLVD 30FT± W + 58FT± N C/L INT MKD (TBM W)	SY 4288
WATTS (1960)	223.897	L+ROUND HD SPK 4FT± E BCR @ SE COR CENTURY BLVD + GRAMERCY PL 45FT± E + 40FT± S C/L INT	SY 4289
WATTS (1960)	222.509	LACE MON @ C/L INT CENTURY BLVD + GRAMERCY PL	SY 4290
WATTS (1960)	183.512	L+T CTR CB RET @ NE COR CENTURY BLVD + VAN NESS AVE 46FT± N + 30FT± E C/L INT	SY 4291
WATTS (1960)	181.445	LACE MON @ C/L CENTURY BLVD + VAN NESS AVE	SY 4292
WATTS (1960)	191.071	L+BR SCREW CTR CB RET @ NE COR CENTURY BLVD + 6TH AVE 44FT± N + 22FT± E C/L INT	SY 4293
WATTS (1960)	48.091	L+BN 1FT± E BCR @ NE COR EL SEGUNDO BLVD + ENT TO NATIONAL CASH REGISTER CO 1000FT± E CRENSHAW BLVD 40FT± N + 43FT± E INT	SY 4307
WATTS (1960)	106.138	L+BN CB 1FT± E BCR @ NE COR DENKER AVE + EL SEGUNDO BLVD 40FT± N + 46FT± E C/L INT	SY 4308
WATTS (1960)	141.590	L+BR CONC SLAB TO BLDG @ NW COR EL SEGUNDO BLVD + BUDLONG AVE 45FT± N + 30FT± W C/L INT	SY 4309

QUAD-YEAR	ELEV	DESCRIPTION (INCLUDE QUAD AND YEAR IN DESCRIPTION)	BM NUMBER
WATTS (1960)	201.704	L+BN W CB 2FT±N BCR @ NW COR 119TH ST + VERMONT AVE W BARREL 36FT±N + 50FT± W C/L INT	SY 4426
WATTS (1960)	201.963	L+BN W CB 1FT±N BCR @ NW COR 117TH ST + VERMONT AVE W BARREL 25T	SY 4427
WATTS (1960)	197.688	L+BN W CB 2FT± S BCR @ SW COR IMPERIAL HWY + VERMONT AVE W BARREL 65FT± S + 21FT± W C/L INT	SY 4428
WATTS (1960)	197.300	BM TAG N CB 1FT± W BCR @ NW COR VERMONT AVE W BARREL 40FT N + 40FT± W C/L INT	SY 4429
WATTS (1960)	190.201	L+T S CB 1FT± W BCR @ SW COR BUDLONG AVE + IMPERIAL HWY 40FT± S + 33FT± W C/L INT MKD (SYBM)	SY 4430
WATTS (1960)	200.533	R D MON IN WELL 8IN DN @ OR NR C/L INT IMPERIAL HWY + NORMANDIE AVE (USE E COR)	SY 4431
WATTS (1960)	202.719	6PT IN CB RET @ NW COR IMPERIAL HWY + NORMANDIE AVE 42FT± N + 44FT± W C/L INT MKD (SYBM)	SY 4432
WATTS (1960)	207.909	RDBM TAG N CB 1FT± E BCR @ NE COR DENKER AVE + IMPERIAL HWY 40FT± N + 45FT± E C/L INT	SY 4433
BASELINE (1955)	77.298	ROUND HD SPK W CB CRENSHAW BLVD 1FT± S BCR @ SW COR IMPERIAL HWY 76FT± S + 40FT± W C/L INT MKD (K E 7)	SY 4768
BASELINE (1955)	76.757	FLT HD NAIL S CB IMPERIAL HWY 12FT± W BCR @ SW COR CRENSHAW BLVD 36FT± S + 85FT± W C/L INT	SY 4769
BASELINE (1955)	159.429	USC+GS DISK TOP OF CONC POST ON AT+SFRR R/W BET W 67TH ST + CRENSHAW BLVD 14FT NWLY OF N RAIL 19FT SLY OF S CB 67TH ST + 5FT N ELY WHISTLE POST MKD (Z 414 1935)	SY 5164
WATTS (1960)	144.757	BR CAP IN WELL @ C/L INT 120TH ST + MAIN ST MKD (WATTS NO 10)	SY 5708
WATTS (1960)	144.977	RDBM TAG S CB 1FT± E BCR @ SE COR MAIN ST + 120TH ST 30FT± S + 43FT± E C/L INT	SY 5709
WATTS (1960)	128.325	HEX DRILL STEEL IN WELL @ X/L INT 120TH ST + SAN PEDRO ST	SY 5710
WATTS (1960)	128.638	SPK S CB 10FT± E BCR @ SE COR SAN PEDRO ST + 120TH ST 30FT± S + 50FT± E C/L INT	SY 5711
BASELINE (1955)	108.242	L+BR @ SW COR CONC ISLAND OF GAS PUMP 65FT± N + 100FT± E C/L INT ROSECRANS AVE + SAN PEDRO ST MKD (BM)	SY 5712
BASELINE (1955)	108.750	L+BR @ SW COR CONC SLAB GAS STA ISLAND 122FT± N + 62FTS8 W C/L INT ROSECRANS AVE + SAN PEDRO ST	SY 5713
BASELINE (1955)	113.257	LACE MON IN WELL @ OR NR C/L INT ROSECRANS AVE + MAIN ST MKD (TRAV STA WATTS D 12)	SY 5714
BASELINE (1955)	114.428	L+N S END CONC HDWL CULV 37FT± N + 24FT W C/L INT ROSECRANS AVE + MAIN ST	SY 5715
BASELINE (1955)	100.163	LACE MON IN WELL @ OR NR C/L INT FIGUEROA ST + ROSECRANS AVE MKD (TRAV STA WATTS C 12 B 1946)	SY 5716
BASELINE (1955)	90.961	L+RCUND HD SPK N CB HARBOR FREEWAY OVERPASS 42FT± N C/L ROSECRANS AVE + 70FT± E C/L OVERPASS	SY 5717

QUAD-YEAR	ELEV	DESCRIPTION (INCLUDE QUAD AND YEAR IN DESCRIPTION)	BM NUMBER
BASELINE (1955)	89.670	L+SPK N CB ROSECRANS AVE 2FT E BCR 159FT W C/L HARBOR FREEWAY OVERPASS + 42FT# N C/L ROSECRANS AVE 23FT E C/L HOOVER ST	SY 5718
WATTS (1960)	136.966	L+T S CB 1FT# W BCR @ SW COR BUDLONG AVE + EL SEGUNDO BLVD 38FT# S + 45FT# W C/L INT	SY 5719
WATTS (1960)	72.176	L+BN N CB 10FT# E BCR @ NE COR WILLOWBROOK AVE E BARREL + WINONA AVE 18FT# N + 35FT# E C/L INT	SY 5720
WATTS (1960)	73.460	L+BN N CB PIRU ST 12FT# E OF CB END 12FT# N C/L PIRU ST + 48FT# E C/L WILLOWBROOK AVE W BARREL	SY 5721
WATTS (1960)	74.444	L+T E CB WILLOWBROOK AVE E BARREL 1FT# N END CB 20FT# E C/L WILLOWBROOK AVE 35FT# N C/L STOCKWELL ST	SY 5722
WATTS (1960)	172.119	CSBM IN WELL 1FT# N OF CB @ NE COR SLAUSON AVE + COMPTON AVE 36FT# E + 30FT# N C/L INT MKD (BM 28 32 1953 RE 63)	SY 5723
WATTS (1960)	173.170	RDBM TAG E CB 4FT# S BCR @ SE COR SLAUSON AVE + COMPTON AVE 30FT# E + 51FT# S C/L INT	SY 5724
WATTS (1960)	166.835	L+T E CB 1FT# N BCR @ NE COR 60TH ST + COMPTON AVE 30FT# E + 32FT# N C/L INT	SY 5725
WATTS (1960)	166.739	L+T E CB 1FT# S BCR @ SE COR 60TH ST + COMPTON AVE 30FT# E + 32FT# S C/L INT	SY 5726
WATTS (1960)	159.099	L+T W CB 1FT# N BCR @ NW COR 64TH ST + COMPTON AVE 30FT# W + 34FT N C/L INT	SY 5727
WATTS (1960)	117.932	LACE MON IN WELL @ C/L INT 95TH ST + CENTRAL AVE	SY 5728
WATTS (1960)	96.059	L+T S CB 1FT# E BCR @ SE COR KEENE AVE + EL SEGUNDO BLVD 38FT# S + 45FT E C/L INT	SY 5729
WATTS (1960)	96.469	L+BN W CB 1FT# S BCR @ SW COR EL SEGUNDO BLVD + KEENE AVE 70FT# S + 15FT# W C/L INT	SY 5730
WATTS (1960)	110.603	L+T S CB 1FT# W BCR @ SE COR STANFORD AVE + EL SEGUNDO BLVD 38FT# S + 45FT# E C/L INT MKD (BM E 1)	SY 5731
WATTS (1960)	110.843	BT SPK E CB 7FT# S BCR @ SE COR EL SEGUNDO BLVD + STANFORD AVE 18FT# E + 66FT# S C/L INT MKD (BM TA 27)	SY 5732
WATTS (1960)	117.677	L+BN W CB 6FT# S END CB 73FT# S C/L 135TH ST + 38FT# W C/L BROADWAY	SY 5733
WATTS (1960)	139.079	L+BN E CB 18FT# N BCR @ NE COR 131ST ST + BROADWAY 40FT# E + 82FT# W C/L INT	SY 5734
WATTS (1960)	116.293	L+FLT HD SPK N CB 20FT# E BCR @ NE COR JUNIPER ST + 92ND ST 15FT N + 45FT# E C/L INT	SY 5735
WATTS (1960)	116.226	L+T N CB 1FT# W BCR @ NW COR JUNIPER ST + 92ND ST 15FT# N + 25FT# W C/L INT	SY 5736
WATTS (1960)	117.640	L+T E CB 8FT# N BCR @ NE COR 92ND ST + FIR AVE 20FT# E + 33FT# N C/L INT	SY 5737
WATTS (1960)	117.712	L+T W CB 6FT# N BCR @ NW COR 92ND ST + FIR AVE 20FT# E + 31FT# N C/L INT	SY 5738

QUAD-YEAR	ELEV	DESCRIPTION (INCLUDE QUAD AND YEAR IN DESCRIPTION)	BM NUMBER
WATTS (1960)	120.871	SPK E CB 2FT± N BCR @ NE COR 92ND ST + HOLMES AVE 20FT± E + 33FT N C/L INT	SY 5739
WATTS (1960)	120.533	L+N S CB 2FT± E BCR @ SE COR HOLMES AVE + 92ND ST 15FT± S + 27FT± E C/L INT	SY 5740
WATTS (1960)	122.598	SPK W CB 1FT± N BCR @ NE COR 92ND ST + GRAHAM AVE 18FT E + 30FT N C/L INT	SY 5741
WATTS (1960)	122.709	SPK S CB 92ND ST 20FT± S C/L 30FT± W /F W RAIL PERR + 110FT± W C/L GRAHAM AVE	SY 5742
BASELINE (1955)	76.242	CS MON IN WELL PKWY @ NW COR CRENSHAW BLVD + 113TH ST 45FT± W + 26FT N C/L INT MKD (BM 27-70A 1960 RE 5869)	SY 5743
WATTS (1960)	118.748	L+T N CB 3FT± W BCR @ NW COR VAN NESS AVE + IMPERIAL HWY 38FT± N + 70FT± W C/L INT	SY 5744
WATTS (1960)	119.458	E CB 2FT± N BCR @ NE COR IMPERIAL HWY + VAN NESS AVE 30FT± E + 80FT N C/L INT	SY 5745
WATTS (1960)	155.623	FLT HD SPK N CB 5FT± E BCR @ NE COR WILTON PL + IMPERIAL HWY N SERVICE ROAD 50FT± E + 80FT± S C/L INT	SY 5746
WATTS (1960)	157.090	FLT HD SPK E CB 30FT± S BCR @ SE COR IMPERIAL HWY + FIGUEROA ST 40FT± E + 85FT± S C/L INT	SY 5747
WATTS (1960)	155.722	BT SPK E CB 1FT± N BCR @ NE COR IMPERIAL HWY + FIGUEROA ST 33FT± E + 60FT± N C/L INT	SY 5748
WATTS (1960)	141.480	CT SPK S CB 25FT± E BCR @ SE COR BROADWAY + IMPERIAL HWY 36FT± S + 60FT± E C/L INT	SY 5749
WATTS (1960)	108.128	CT SPK W CB 5FT± S BCR @ SW COR 111TH PL + AVALON BLVD 38FT± S + 20FT± W C/L INT	SY 5750
WATTS (1960)	110.171	WIRE SPK E CB 6FT± S BCR @ SE COR 109TH PL TO E + AVALON BLVD 25FT± E + 38FT± S C/L INT	SY 5751
WATTS (1960)	110.003	SPK W CB 5FT N BCR @ NW COR AVALON BLVD + 109TH PL 25FT W + 28FT N C/L INT (109TH PL TO W)	SY 5752
WATTS (1960)	114.415	L+T E CB 11FT± S BCR @ SE COR 104TH ST + AVALON BLVD 30FT± E + 50FT± S C/L INT	SY 5753
WATTS (1960)	118.768	L+T E CB 15FT± S BCR @ SE COR CENTURY BLVD + AVALON BLVD 30FT± E + 70FT± S C/L INT	SY 5754
WATTS (1960)	118.873	L+BN N CB 4FT± E BCR @ NE COR AVALON BLVD + CENTURY BLVD 36FT± N + 63FT± E C/L INT	SY 5755
WATTS (1960)	115.190	HEX DRILL STEEL IN WELL @ C/L INT CENTURY BLVD + MCKINLEY AVE	SY 5756
WATTS (1960)	184.943	L+SPK N CB 5FT± W BCR @ NW COR BUDLONG AVE + 120TH ST	SY 5757
WATTS (1960)	188.931	L+T CTR CB RET @ S COR BUDLONG AVE + 120TH ST 2FT± NR D TAG	SY 5758
WATTS (1960)	191.006	RDBM TAG E CB 50FT± N BCR @ NE COR NORMANDIE AV 120TH 100FT N + 30FT E C/L INT	SY 5759
WATTS (1960)	191.339	RDBM MON IN WELL 8IN DN C/L NORMANDIE AVE 26FT± S PROPOSED C/L 120TH ST MKD (LA CO R D 1951)	SY 5760

OUT

QUAD-YEAR	ELEV	DESCRIPTION (INCLUDE QUAD AND YEAR IN DESCRIPTION)	BM NUMBER
WATTS (1960)	182.019	RDBM TAG E CB DENKER AVE 180FT± S C/L 120TH ST	SY 5761
WATTS (1960)	181.974	RDBM TAG W CB DENKER AVE 180FT± S C/L 120TH ST	SY 5762
WATTS (1960)	84.981	L+BR E CB 1FT± N BCR @ NE COR 120TH ST + VAN NESS AVE 68FT± N + 30FT± E C/L INT MKD (MB)	SY 5763
WATTS (1960)	83.030	CS TAG W CB 4FT± S BCR @ SW COR 120TH ST + VAN NESS AVE 70FT± S + 30FT± W C/L INT	SY 5764
BASELINE (1955)	57.845	FC BR CAP DISC SW COR CATCH BASIN @ NE COR DOMINGUES CHANNEL + CRENSHAW BLVD MKD (BM 114-51)	SY 5765
BASELINE (1955)	57.558	SPK CONC FOOTING NE COR FENCE POST AIRPORT SW COR 120TH ST + CRENSHAW BLVD	SY 5766
BASELINE (1955)	139.447	CS MON TOP CONC POST 12IN DN 1FT± W OF E CB ALAMEDA ST ON C/L PROD NADEAU ST MKD (WATTS 1 4A 1938 RE 2177)	SY 5767
BASELINE (1955)	135.415	CS MON INGRANITE POST SPRR ABUT 0.4MI± N FIRESTONE BLVD 90FT± N OF STA + 11FT± E OF E RAIL MKD (A33 1920)	SY 5768
BASELINE (1955)	117.783	CS MON 2IN DN ON ALAMEDA ST 134FT± N C/L 92ND ST + 40FT± W OF W RAIL SPRR MKD (WATTS 1 6 RE 2177 1938)	SY 5770
BASELINE (1955)	120.280	CS MON CONC FOUNDATION SW LEG TRANSMISSION LINE TOWER NO 265D3 66FT± E C/L ALAMEDA ST + 118FT± N C/L SOUTHERN AVE MKD (LC 769 1945)	SY 5771
BASELINE (1955)	111.765	CS BR CAP 2IN DN ON ALAMEDA ST 28FT± W OF W RAIL SPRR ON N EDGE PVMT TWEEDY BLVD MKD (WATTS 1 7A RE 2177 1938)	SY 5772
BASELINE (1955)	113.968	R D MON CONC BASE OF RR CROSSING SIGN NO B 6 491 40FT± W OF W EDGE PVMT ALAMEDA ST 30FT N C/L TWEEDY BLVD MKD (BM 30)	SY 5773
BASELINE (1955)	103.387	CS MON IN CONC POST 2IN UP 1FT± E OF E CB ALAMEDA ST + 199FT± N C/L CENTURY BLVD	SY 5775
BASELINE (1955)	102.457	CS MON IN CONC POST 3FT± W OF W CB ALAMEDA ST + 199FT± N C/L CENTURY BLVD	SY 5776
BASELINE (1955)	99.713	CS MON 36IN DN ON ALAMEDA ST 20FT± W OF W RAIL SPRR + 17FT± N OF N EDGE PVMT CENTURY BLVD MKD (WATTS I 8 RE 2177 1938)	SY 5777
BASELINE (1955)	97.716	CS MON FLUSH ON ALAMEDA ST 34FT± W OF W RAIL SPRR + 16 FT± S RAIL CROSSING SIGNAL (A) TS I 9 RE 21771939)	SY 5778
BASELINE (1955)	91.794	LACE HEX MON IN WELL 32FT± E C/L ALAMEDA ST + 34FT± S C/L IMPERIAL HWY	SY 5779
BASELINE (1955)	91.669	L+FLT HD SPK 10FT± S BCR @ SE COR 25FT± E C/L ALAMEDA ST + 70FT± S C/L IMPERIAL HWY	SY 5780
WATTS (1960)	88.165	L+T S CB 1FT± W BCR @ SW COR MONA AVE + IMPERIAL HWY 40 FT± S + 30FT± W C/L INT	SY 5781
WATTS (1960)	89.672	6+T S CB 1FT± E BCR @ SE COR GORMAN AVE + IMPERIAL HWY 40FT S + 33FT E C/L INT	SY 5782